

TWINS connection (M871-A...L)

1

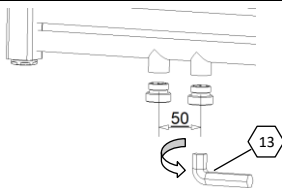

Attention:

Make sure not to damage the o-ring, which is responsible for the tightness between the heater and the nipple, when tightening it.

2.a
(PEX 16x2)

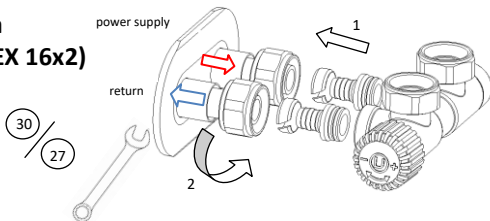

Attention:

Power supply on the side of the cut-off insert !! Before installing the connectors, it is possible to install the rosette and masking sleeves in the color of the connection (additional equipment).

Make sure that when installing the 16x2 coupler, do not damage the o-rings responsible for the tightness of the coupler between the installation and the connection.

3

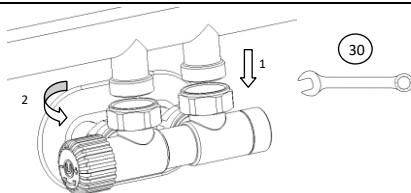

4

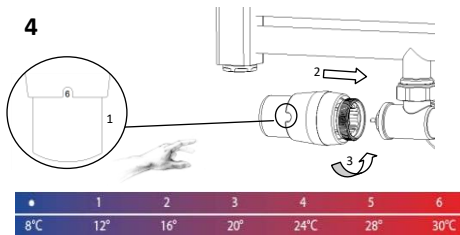

5

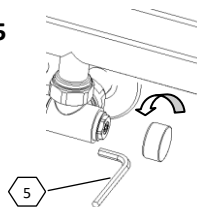

Attention:

Flow regulation in accordance with the Product Data Sheet (www.varioterm.pl/en/download/data-sheets).

2.b (Cu 15x1)

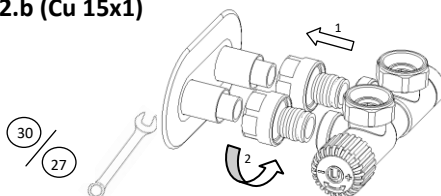

Attention:

Power supply on the side of the cut-off insert !!

Before installing the connectors, it is possible to install the rosette and masking sleeves in the color of the connection (additional equipment). Remove sharp material residues from the outside of the tubing that may damage the o-rings inside the fitting when pressing onto the tubing. After crimping the coupler, first check that it is not possible to turn and / or slide the tube out by pulling it STRONGLY, and then check the hydraulic tightness. Maintain a 90° angle between the tube and the heater.

Terms of warranty:

- The manufacturer provides a warranty for a period of 3 years from the date of purchase.
- Defects revealed during the warranty period will be removed free of charge within 14 business days from the date of their notification.
- Notification of a defect or damage is accepted by e-mail: biuro@varioterm.pl or by phone (022) 8724214.
- In order to perform a warranty repair, the defective product must be delivered to the VARIO TERM office with a description of the reason complaints and a copy of the proof of purchase with the stamp of the facility where the purchase was made and clearly marked with the date of purchase.
- The warranty does not cover parts that are subject to natural wear and tear during their lifetime, and defects caused as a result of installation and use inconsistent with the instructions, defects bearing signs of mechanical or thermal damage or signs of user interference.
- The Purchaser loses all rights resulting from the guarantee in the event of: 1) loss or destruction of the proof of purchase, 2) unauthorized repairs, disassembly, 3) improper or inconsistent with the instructions for use.